

Thank you for purchasing Tifosi Optics eyewear!
Please read all pertinent information below
concerning your recent purchase.

ENGLISH

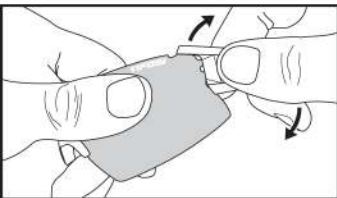

TIFOSI PRO - SHIELD (FRAMELESS)

TO REMOVE ARMS:

1. With the sunglass facing towards you, grip the lens with your thumb in front and index finger behind. With your opposite hand, grab the top of the sunglass arm and, with your thumb and index finger, gently pull the top pointed arm piece upwards and away from the lens.
2. Pivot the sunglass arm down and away from the lens. Repeat for opposite arm.

3. To remove the nose piece: With the back of the lens facing towards you, use your thumb and index finger to firmly grasp the lens. Using the thumb and index finger of your opposite hand, grip the bridge of the nose piece and gently twist laterally away from the lens until it releases.

TO INSTALL ARMS:

1. Start by replacing the nose piece. Holding the lens firmly with one hand, use your opposite hand to guide the nose piece into the notch on the lens. Making sure the nose pads are oriented correctly, gently push the nose piece towards the notch in the lens until it snaps into place.

ENGLISH

2. Next, with the lens facing towards you, grip it with your thumb in front and your index finger behind. Holding the arm with your opposite hand, fit the bottom lens anchor into the bottom notch of the arm.
3. Pivot the arm upwards until it snaps into place. Repeat for opposite arm.

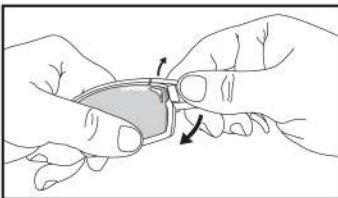

TIFOSI PRO - FULL FRAME

TO REMOVE ARMS:

1. With the sunglass facing towards you, grip the frame with your thumb on the bottom and index finger on top. With your opposite hand, grab the top of the sunglass arm and, with your thumb and index finger, gently pull the top pointed arm piece upwards and away from the lens.
2. Pivot the sunglass arm down and away from the lens. Repeat for opposite arm.

TO INSTALL ARMS:

1. With the sunglass facing towards you, grip the frame with your thumb on the bottom and index finger on top. Holding the arm with your opposite hand, fit the bottom lens anchor into the bottom notch of the arm.
2. Pivot the arm upwards until it snaps into place. Repeat for opposite arm.

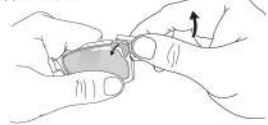

ENGLISH

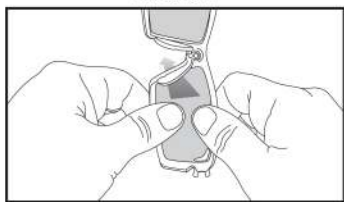

TO REMOVE A LENS

(Note: Lenses Must Be Changed One At A Time):

1. You must remove the arms from the frame before removing the lenses. See arm removal instructions above.
2. With the sunglasses facing down and the arms removed, hold the top and bottom of the frame with both hands.
3. Place your fingers on the front side of the frame and your thumbs on the back side of the frame while letting your thumbs rest on the lens.
4. Gently flex/spread the frame apart with your fingers as you press down on the lens with your thumbs, releasing the lens to the front of the sunglass.
5. Repeat steps 1 – 4 with the opposite lens.

TO INSTALL A LENS

(Note: The Lens with the Tifosi logo is the left eye lens):

1. You must remove the arms from the frame before installing the lenses. See arm removal instructions above.
2. With the sunglasses facing up and the arms removed, place the lens over the frame and line it up with the groove on the outside corner.
3. Place your finger on the back side of the frame and your thumbs on the front side bracing the lens over the frame.
4. Gently flex/spread the frame with your fingers as you guide the lens down into the outer corner of the frame with your thumbs.
5. Press the inner and outer edges of the lens into the frame with your thumbs.
6. Make sure that the lens is seated in the frame by squeezing the outside perimeter of the frame.
7. Repeat install steps 1 – 5 with the opposite lens.
8. Install the arms as instructed above.

ENGLISH

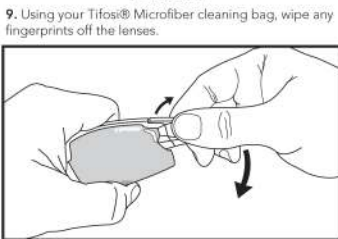

TIFOSI PRO - HALF FRAME

TO REMOVE ARMS:

1. With the sunglass facing towards you, grip the frame with your thumb on the bottom edge of the lens, and index finger on the top edge of the frame. With your opposite hand, grab the top of the sunglass arm and, with your thumb and index finger, gently pull the top pointed arm piece upwards and away from the lens.
2. Pivot the sunglass arm down and away from the lens. Repeat for opposite arm.

TO INSTALL ARMS:

1. With the sunglass facing towards you, grip the frame with your thumb on the bottom and index finger on top. Holding the arm with your opposite hand, fit the bottom lens anchor into the bottom notch of the arm.
2. Pivot the arm upwards until it snaps into place. Repeat for opposite arm.

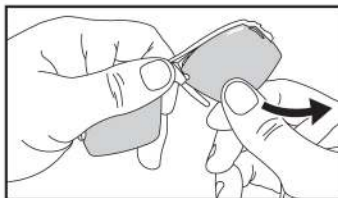

TO REMOVE A LENS

(Note: Lenses Must Be Changed One At A Time):

1. With the sunglasses facing you and the arms fully extended, pinch the nose bridge with your thumb and

index finger. Pinch the outside edge of the lens with your opposite thumb and index finger.

2. Gently pull your hands apart as you pivot the lens down and out of its socket at the nose piece.
3. Pull the lens down and out of its anchor at the outside of the frame.
4. Repeat steps 1 – 3 with the opposite lens.

TO INSTALL A LENS

(Note: The Lens with the Tifosi logo is the left eye lens):

1. Place the lens anchor into the outside corner of the frame.
2. Pivot the lens back up towards the nose piece making sure that the top of the lens fits into its slot under the top of the frame.
3. Placing the bottom of the lens in your palm and your fingers on top of the frame, compress the lens back into its socket until it clicks into place.
4. Repeat steps 1 – 2 with the opposite lens.
5. Using your Tifosi® Microfiber cleaning bag, wipe any fingerprints off the lenses.

NOTE: Your Tifosi Pro eyewear interchangeable set may not include all frame options listed. Please follow the installation & dismantle instructions for your specific set by matching them up with the illustrations.

CE Cleaning and Maintenance: Use the microfiber cleaning bag for storage and protection. If glasses are dirty, use the cleaning bag to wipe them. If needed, rinse with mild soap and warm water. We recommend regular cleaning and wiping to help maintain the lenses.

Disclaimer: Not suitable for direct observation of the sun or strong artificial light sources. Tifosi Optics does not recommend tinted lenses to be used for night driving. Tifosi Optics eyewear meets the ANSI Z-80.3 standard. They are not defined as safety glasses, and they should in no way be regarded as a shield against the risk of accident or injury in the event of impact with a hard surface. The lens(es) must be properly secured in the frame at all times. For lens changing instructions, please see details above or go to: www.tifosioptics.com/about/lens-changing-instructions

RX Lens: RX eyewear lenses should not be removed or interchanged at any time.

atings: Tifosi Optics lenses are 100% UVA/UVB protected and satisfies the US FDA Reg 21 CFR 801.410 ANSI Z-80.3-2008 and EN ISO 12312-1:2013 standards for optical and mechanical performance. Each lens color has a different light transmission; please visit our website to see the light transmission percentage for any specific Tifosi Optics lens at: www.tifosioptics.com/technology/lens

Patents: For information on Tifosi Optics Patents, please visit: www.tifosioptics.com/patents

Warranty: For warranty information in the United States, please go to: www.tifosioptics.com/warranty

Please note that warranty may not apply in all countries due to various laws and regulations. Customers outside the United States may contact their local Authorized Tifosi Optics Distributor.

For a listing of Authorized International Distributors, please visit: www.tifosioptics.com/where-to-buy/international-distributors

Use and Care

Use and maintenance of eyeglasses and sunglasses.

Use

Tifosi sunglasses and protective filters protect eyes from the dangerous and unpleasant effects of sunlight. All TIFOSI sunglasses meet the essential safety requirements covered by the European Directive 89/686/EEC Directive and its amendments, and are also consistent with the standard EN ISO 12312-1:2013.

Brand

The model identification is located inside of the frame. The category filter, as determined by the European standard EN1836 and specified in the table below, appears on the box of glasses you have purchased. When multiple filter categories are present, they identify the class of different glasses filters proposed (models with interchangeable lenses) or if it is a photochromic glass, they identify the category glasses filter in its clearest state and darkest state.

Terms of Use

It is not recommended to wear sunglasses while driving in conditions of reduced visibility or at night. TIFOSI sunglasses should not be used to look directly at the sun, or as protection against the light from artificial light sources such as tanning lamps. The sensitivity to light and glare, especially in bright

lighting conditions such as the presence of snow, on the beach or at sea depends on one person to another. However, it is important to consider the fact that lighting filter categories 0 and 1 only slightly reduce sunlight in the field of vision, while ensuring sufficient protection against UV rays. In normal use, the glasses sun and protective filters provide sufficient protection. However, they should not be used as protection against blows or impacts that could break the glass, causing injury to face and eyes.

Storage

TIFOSI sunglasses should be kept in their case, to a temperature between 35° - 10° C. Avoid exposure to sun without air conditioning in closed environments such as the dashboard of the car, because temperatures reached in these conditions can damage the functionality of the glasses. If the sunscreens are worn (eg, scratched or opaque), it is recommended to replace with genuine spare TIFOSI original parts.





Cleaning

Use warm water and mild liquid detergent. Dry glasses with a soft clean cloth. Avoid the use of solvents, such as alcohol and acetone, and of aggressive cleaning chemicals, as these may impair the functionality of the glasses.

Imported For

Tifosi Optics, Inc.
1011 Industrial Blvd.
Watkinsville, GA 30677
United States



Filter Category	Description	Usage	Symbol
0	Light Tint Sunglasses.	Very limited reduction of sunlight.	
1		Limited reduction of sunlight.	
2	General Purpose Sunglasses.	Good protection against sunlight.	
3		High protection against sunlight.	
4	Very dark, special purpose sunglasses. Very high sunglare reduction.	Very high protection against extreme sun radiation, such as at sea, over snowfields, on high mountains or in desert.	